

YONG YUAN VALVE

FORGED STEEL LIFT CHECK VALVE

YSL SERIES

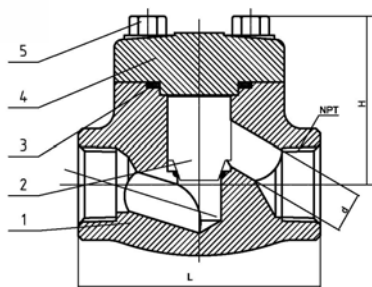

Features:

- Conventional Port
- Spring Loaded Optional
- Design and Manufacture: API602
- Threaded ends to ANSI B1.20.1(NPT)
- Socket-weld dimension: ASME B16 .11
- Pressure-temperature ratings: ASME B16.34
- Inspection and Test: API598
- NACE MR-01-75

Parts & Materials

No.	Part	Material
1	BODY	Forged Carbon Steel ASTM A105
2	DISC	Stainless Steel A182-Fa6
3	GASKET	Stainless Steel A276-304+GRAPHITE
4	BONNET	Forged Carbon Steel ASTM A105
5	BOLT	Carbon Steel A193-B7



Dimensions(in)

NPS	PART#	L	d	H	NPT	Weight (lbs)
1/4(FP)	YSL02A8	3.11	0.28	2.40	1/4	2.64
3/8(FP)	YSL03A8	3.11	0.35	2.40	3/8	3.31
1/2	YSL04A8	3.11	0.35	2.40	1/2	3.31
3/4	YSL05A8	3.62	0.51	2.40	3/4	3.75
1	YSL06A8	4.37	0.69	3.07	1	7.28
1-1/4	YSL07A8	4.72	0.91	3.31	1-1/4	9.26
1-1/2	YSL08A8	5.98	1.18	3.31	1-1/2	14.22
2	YSL09A8	6.77	1.38	4.65	2	23.15

TEL:0086-579-8715288
E-mail:cnyvc@cnyvc.com

0086-579-8725688
yu@cnyvc.com

FAX:0086-579-87151442
HTTP:www.oil-fieldvalve.com